

# INSTRUCTIONS PHOTO ETCHED DETAILS FOR REVELL 05093 TYPE: VIIC 1/350

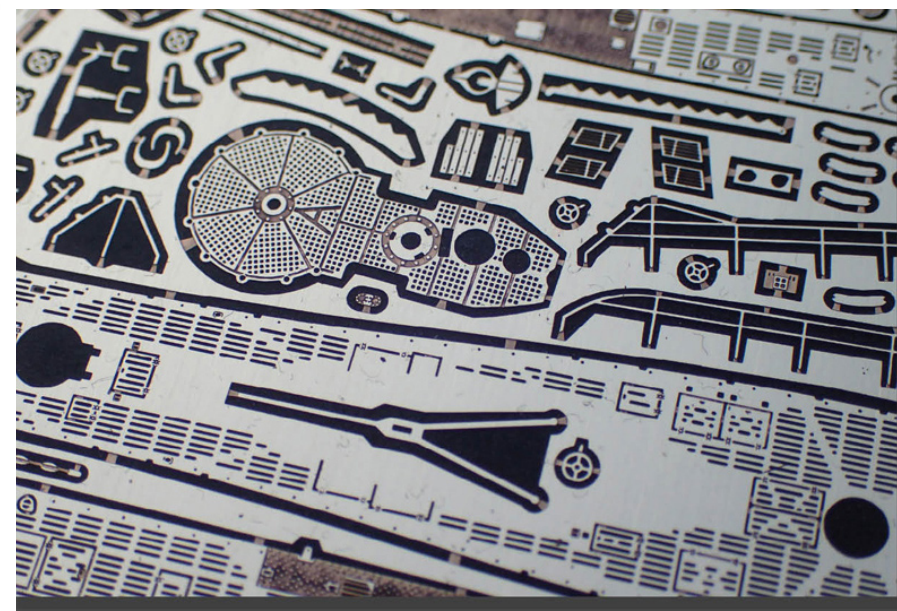

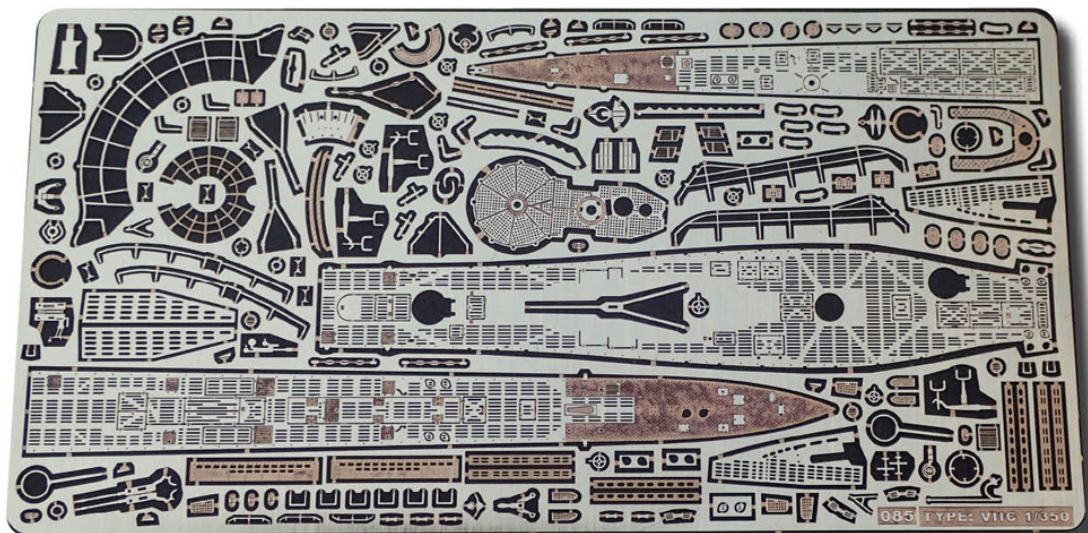

# Description of parts PE

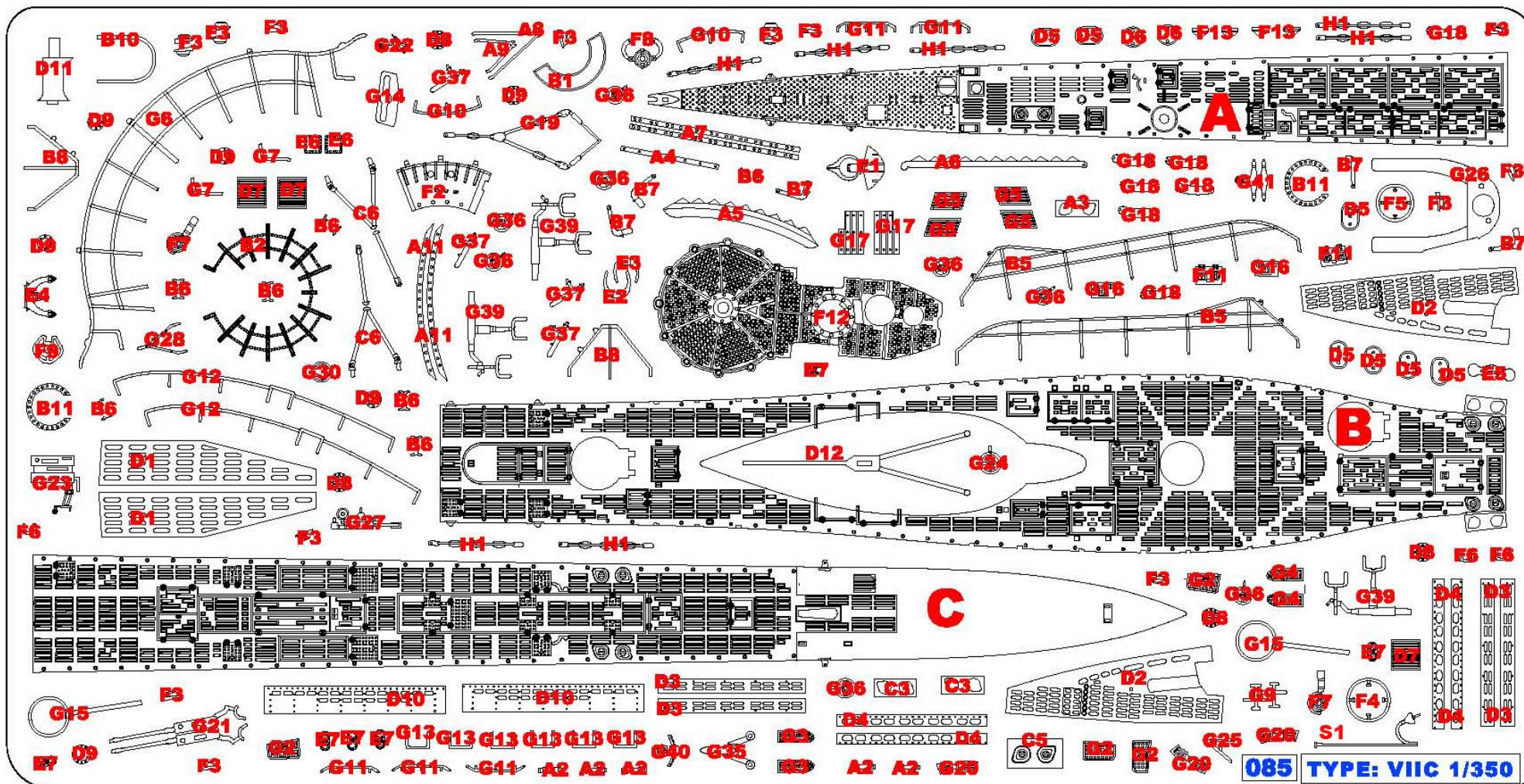

# Hull -forming etchings

For a better shaping of etching, it is necessary to heat up plate and then rapidly cool down. etching is soft and well shaped according to the shape of the hull.

Recommendation: Try these steps to shape a different part of the sheet (the rest).

1.

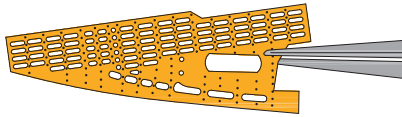

for thin sheet metal the heating must not be high



2.

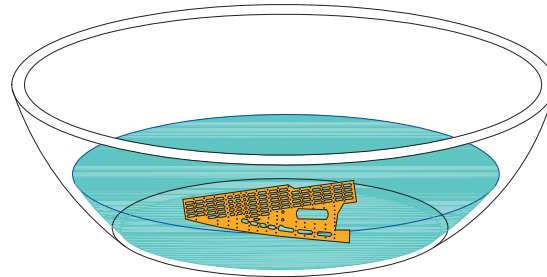

3.

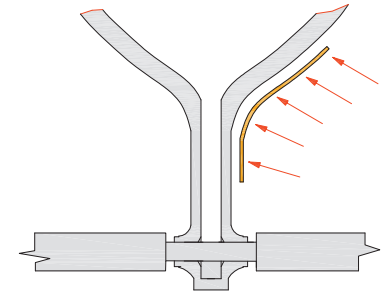

1.

fine melting to determine the outline etching (using solder)

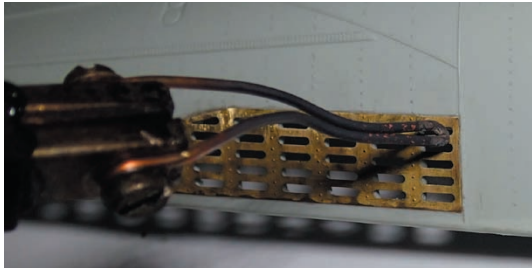

2.

formation of holes using a milling machine



3.

melting etching into the hull

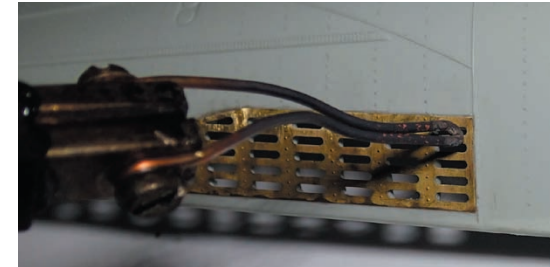

4.

gluing and kiting

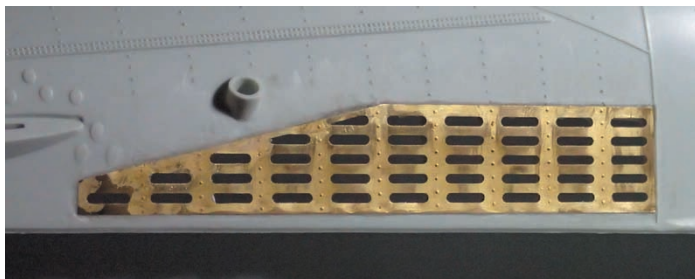

# Deck system

3 Glue (adhesive solidification time delay)

2 grind the entire surface

1 Glue

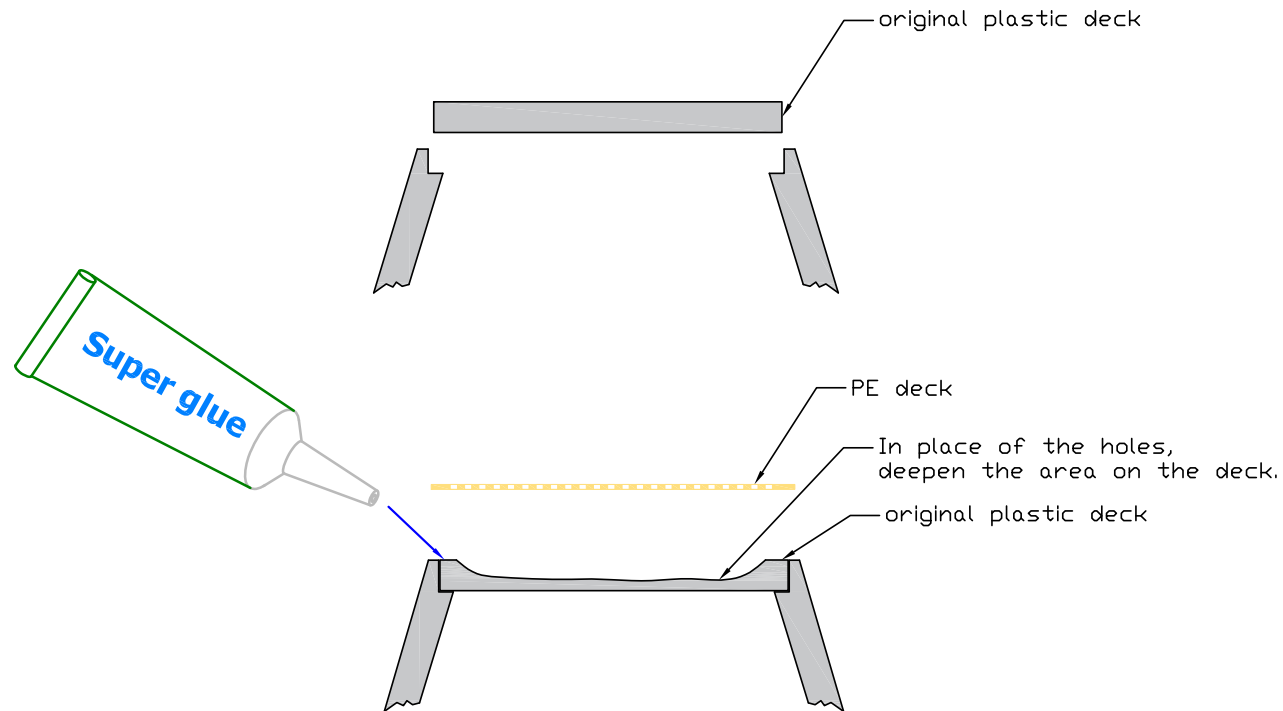
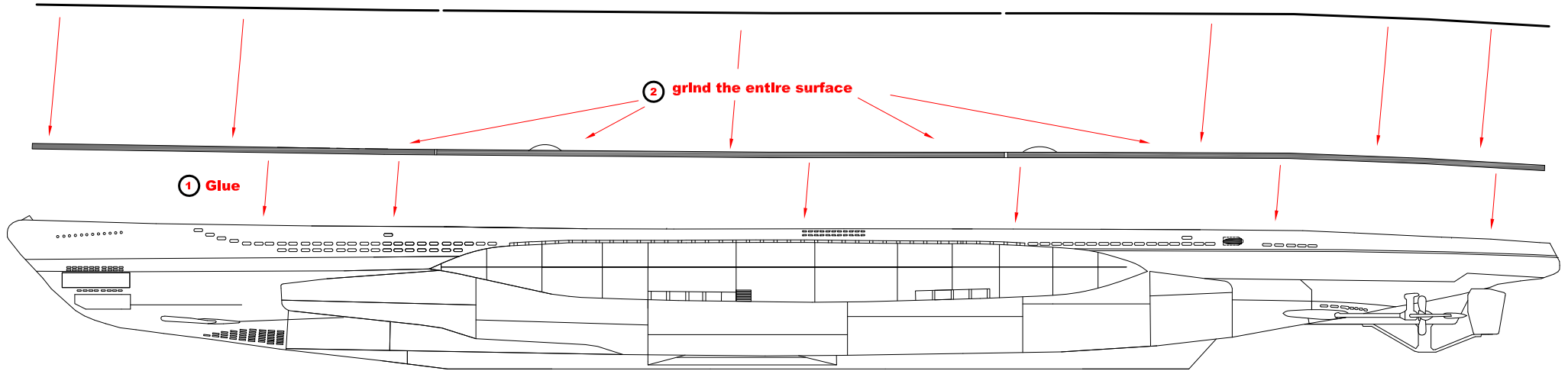



# Deck A

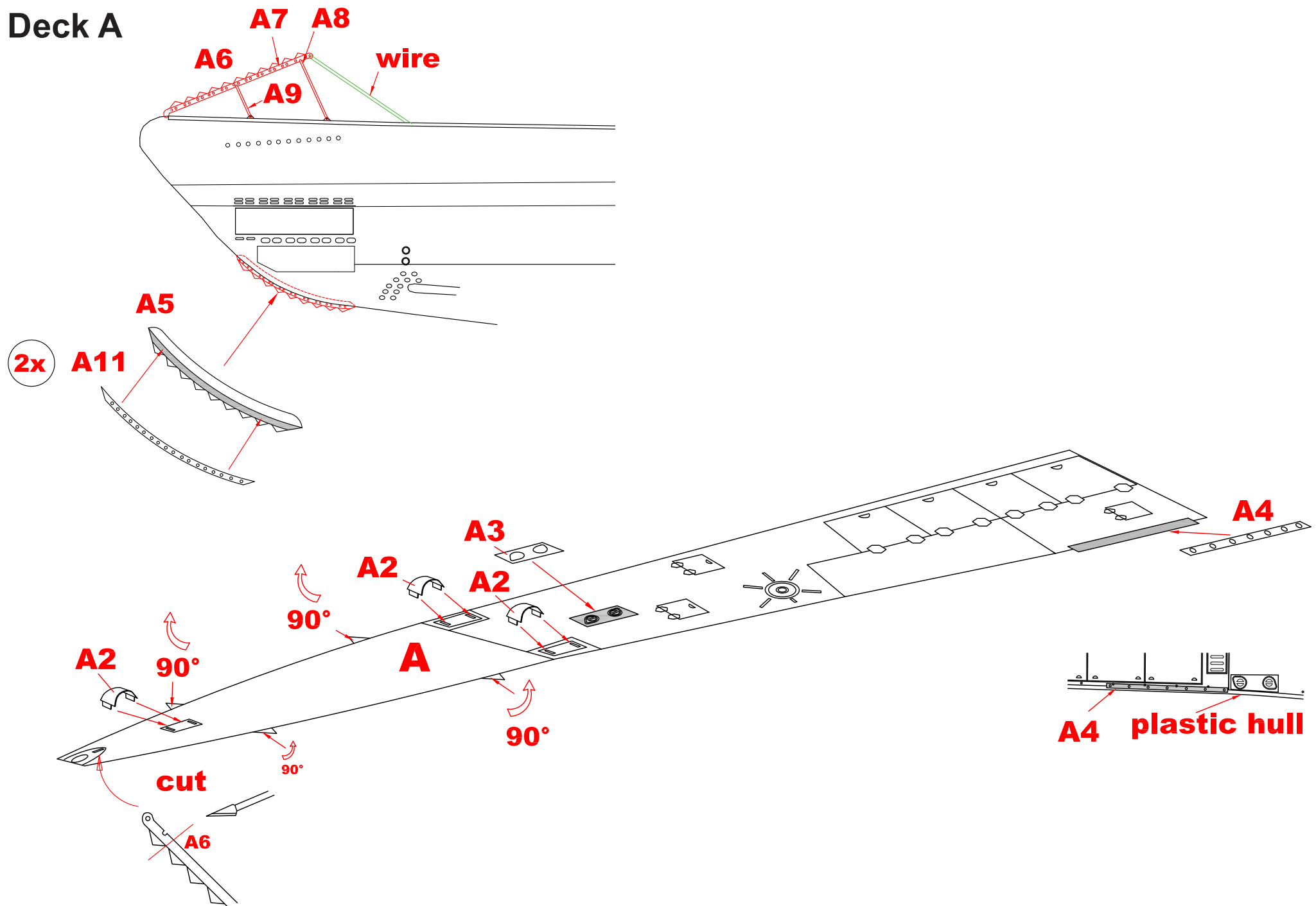

# Deck B

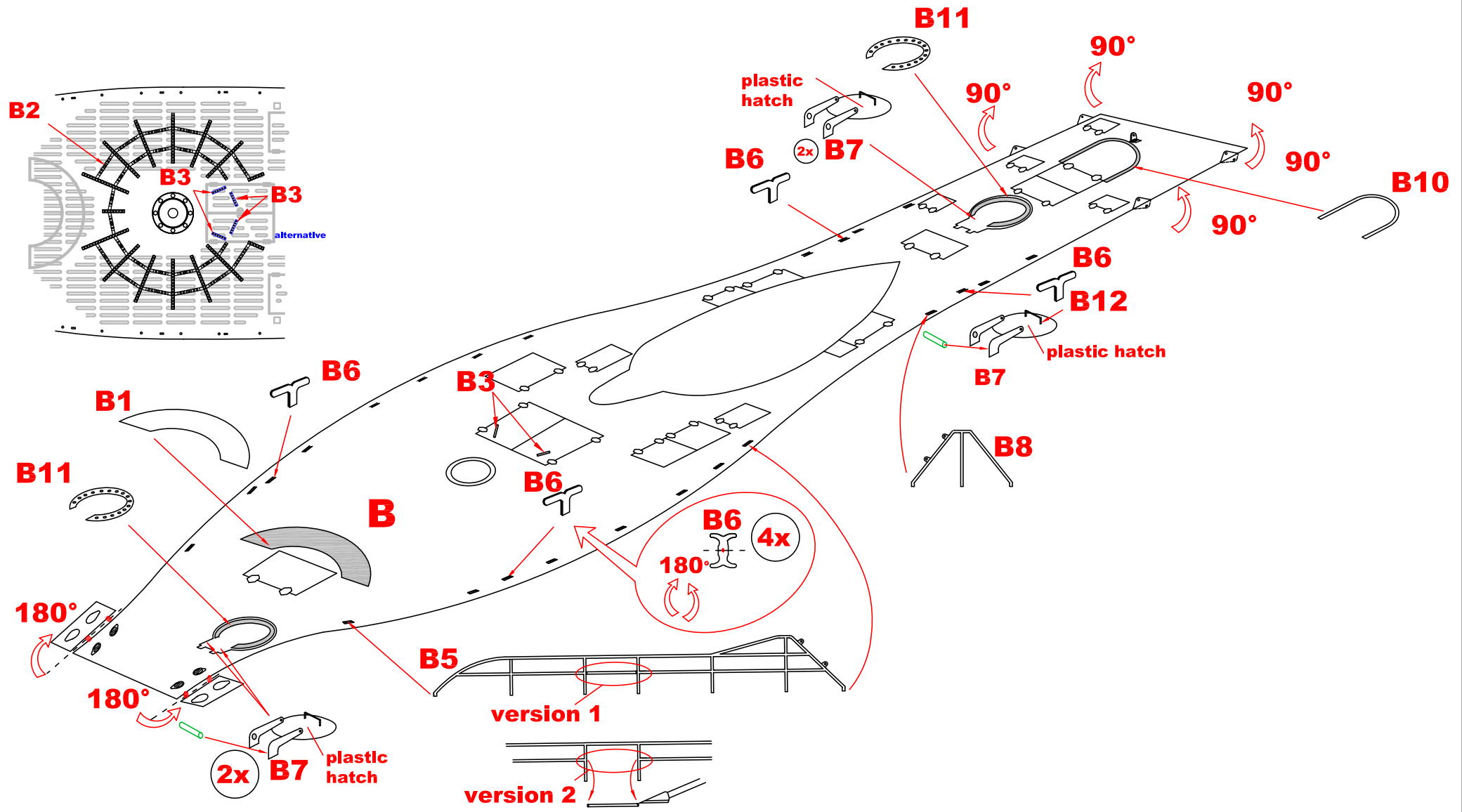

# Deck C

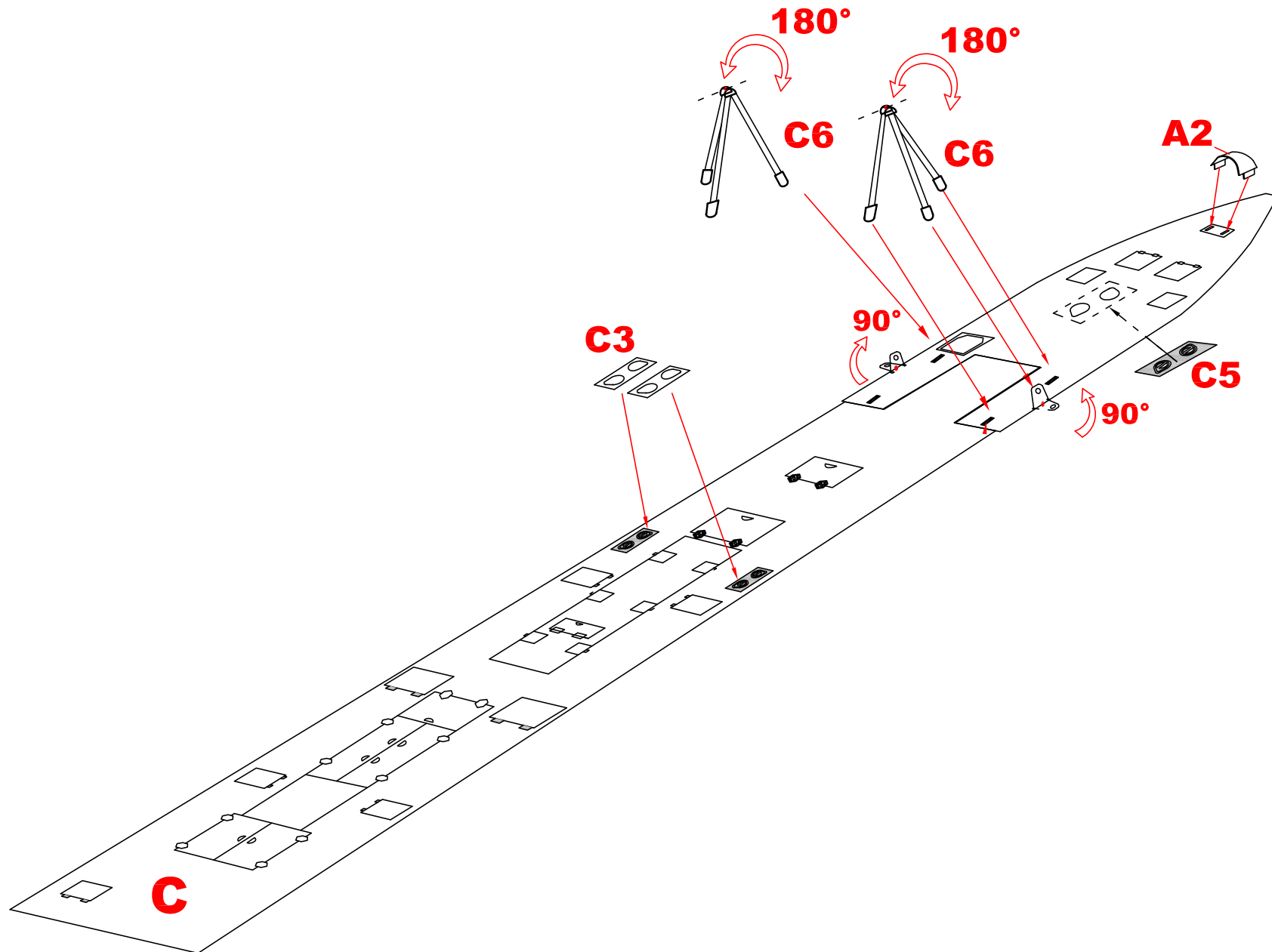

# HULL

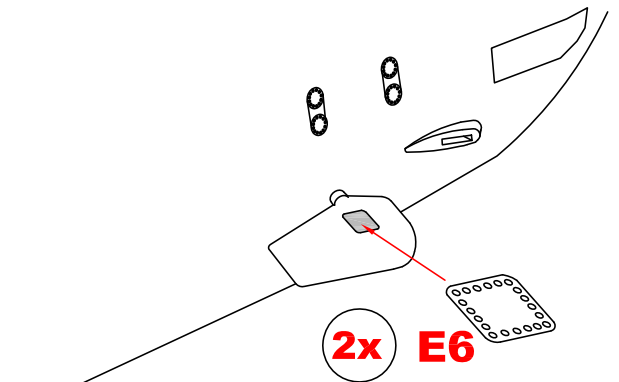
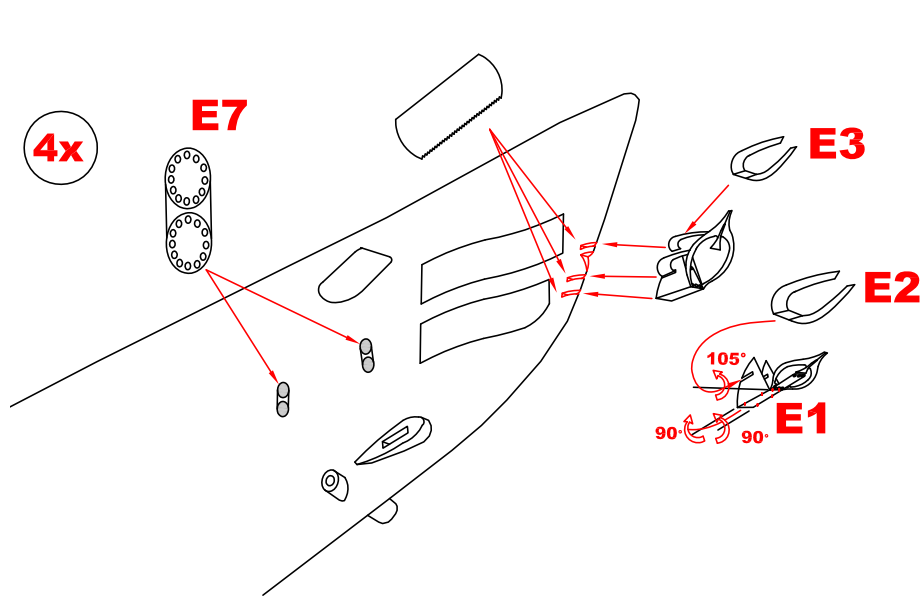

**REVELL**  
**plastic part**

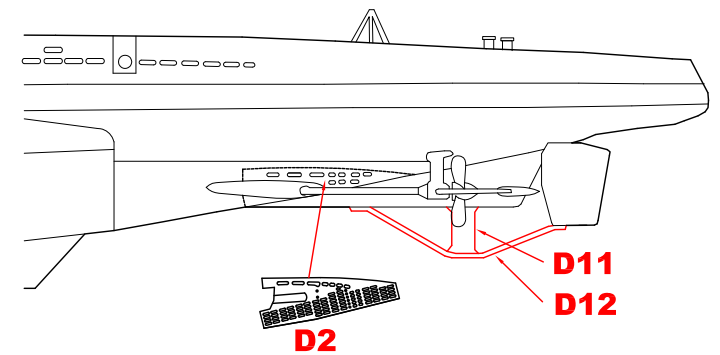
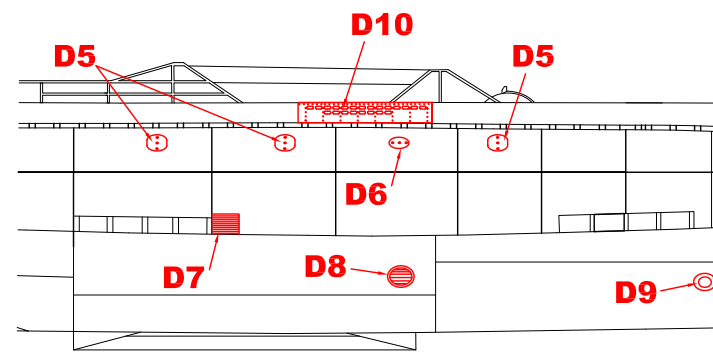
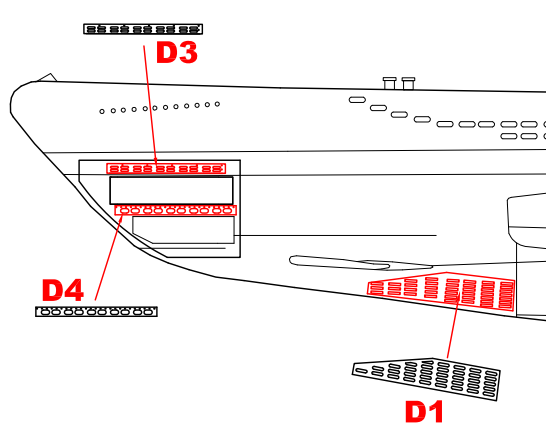



# HULL

**REVELL**  
plastic part

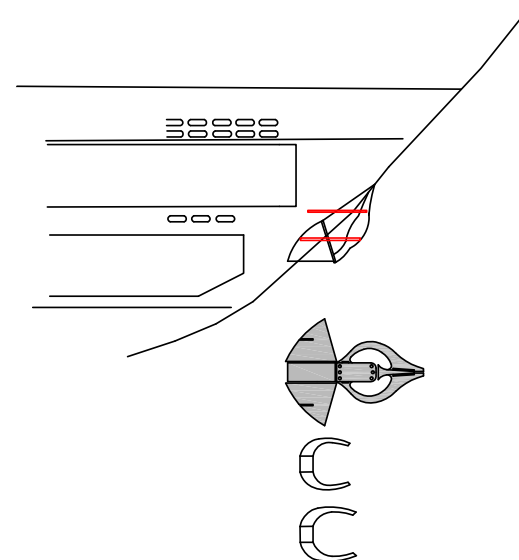
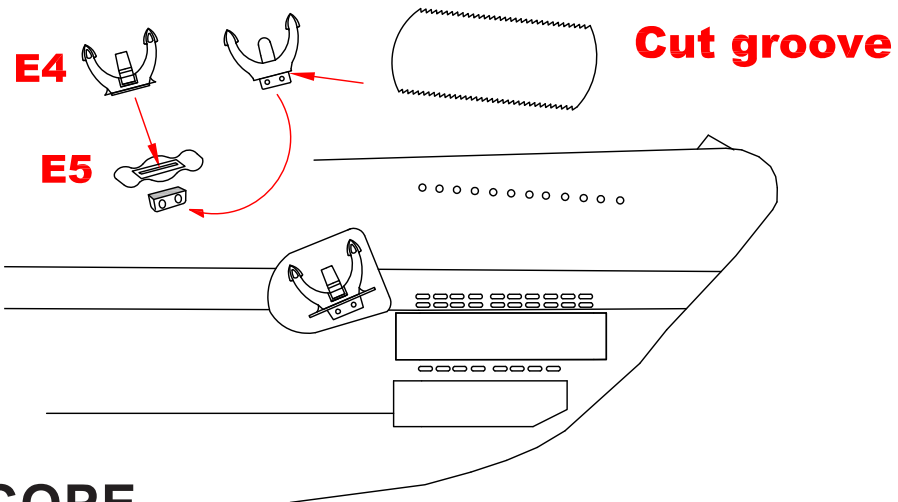

# PERISCOPE

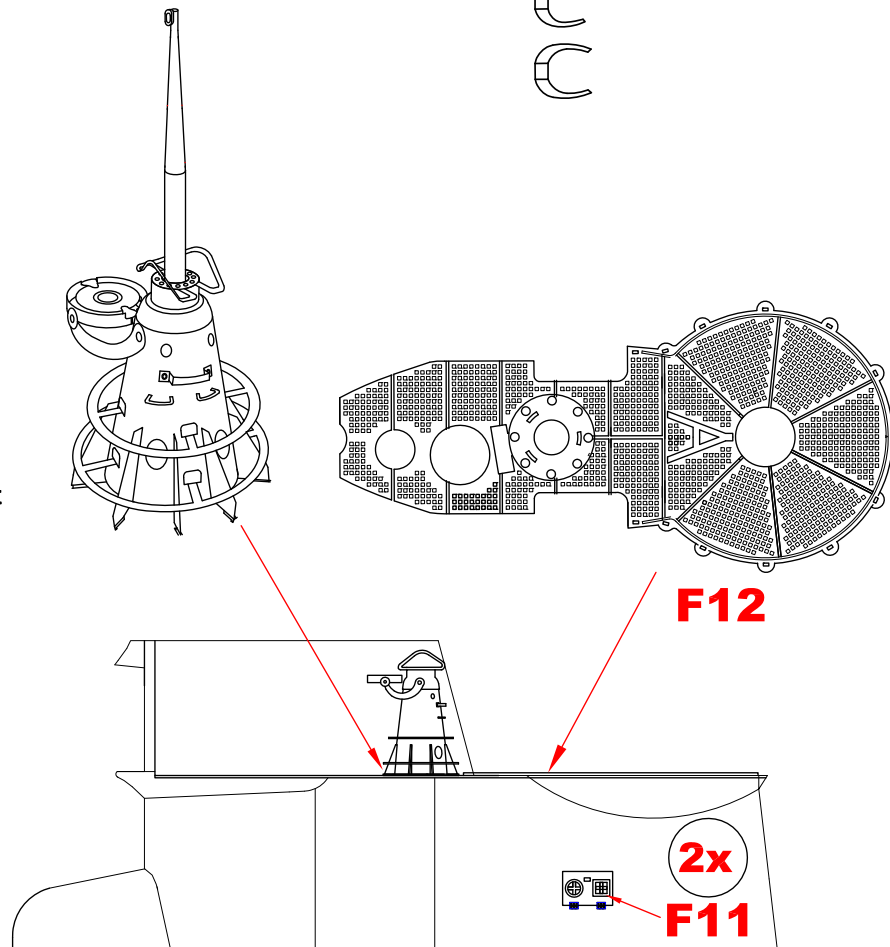
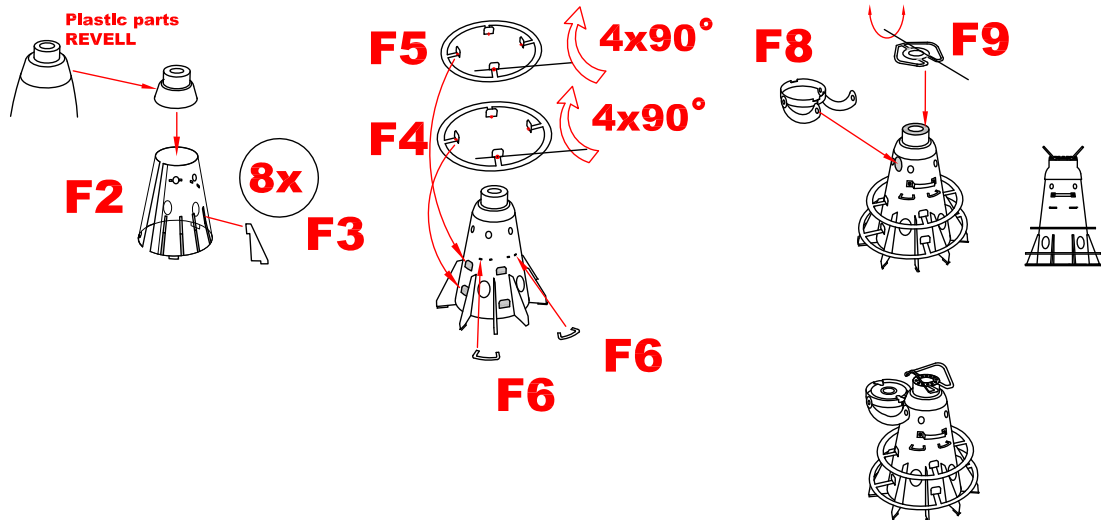

# TOWER

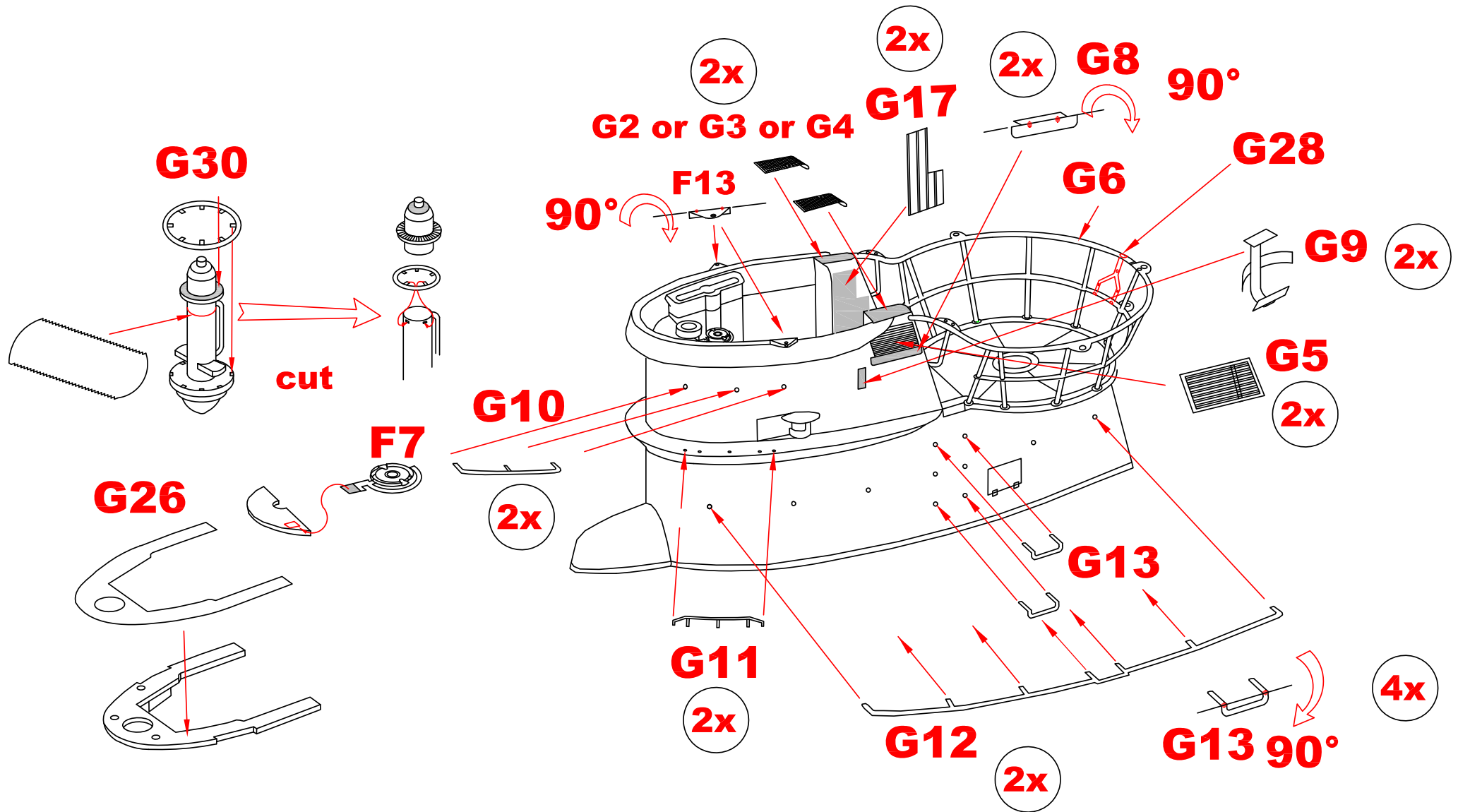

# GUN 20 MM

## TOWER

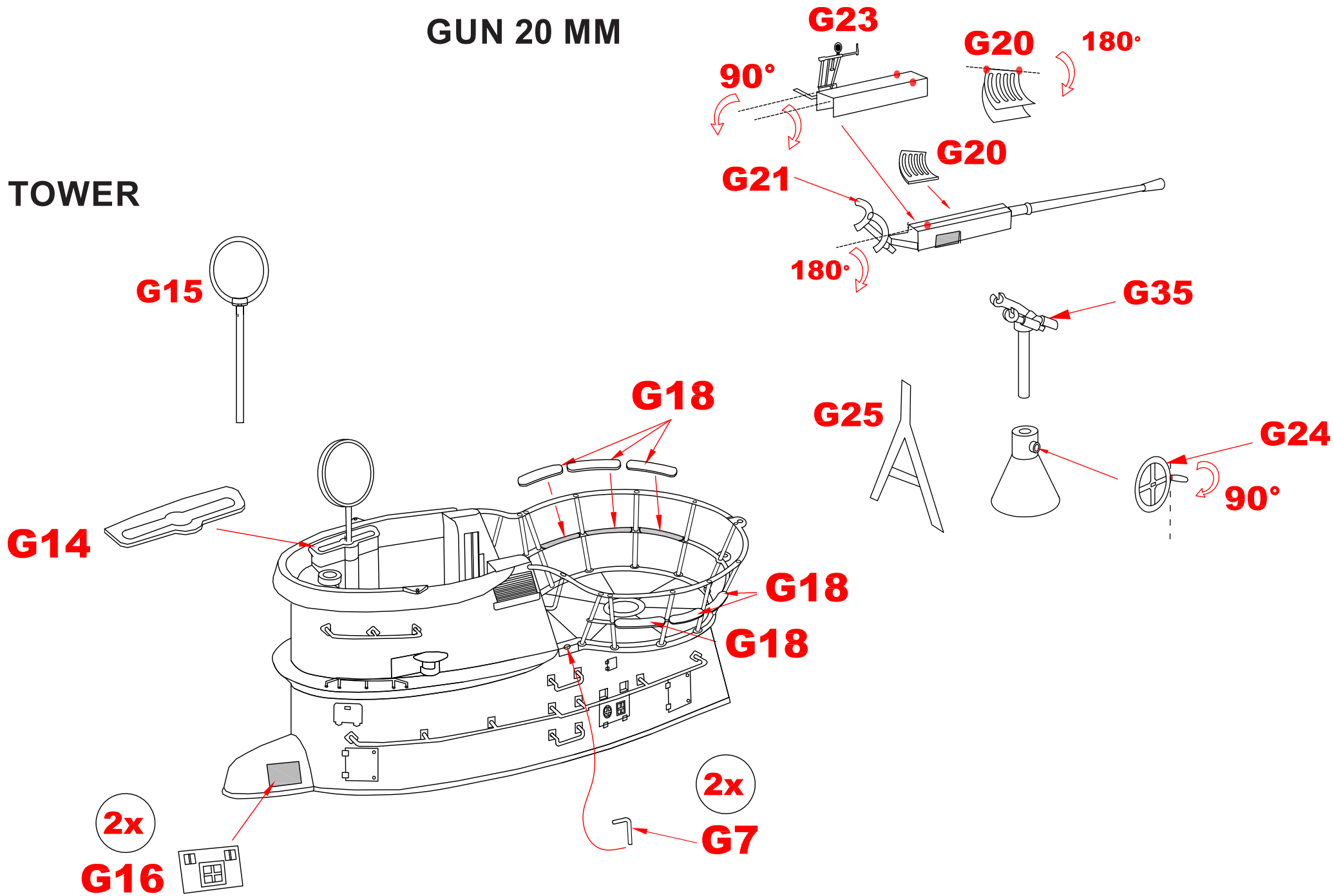

# DECK GUN 88 MM

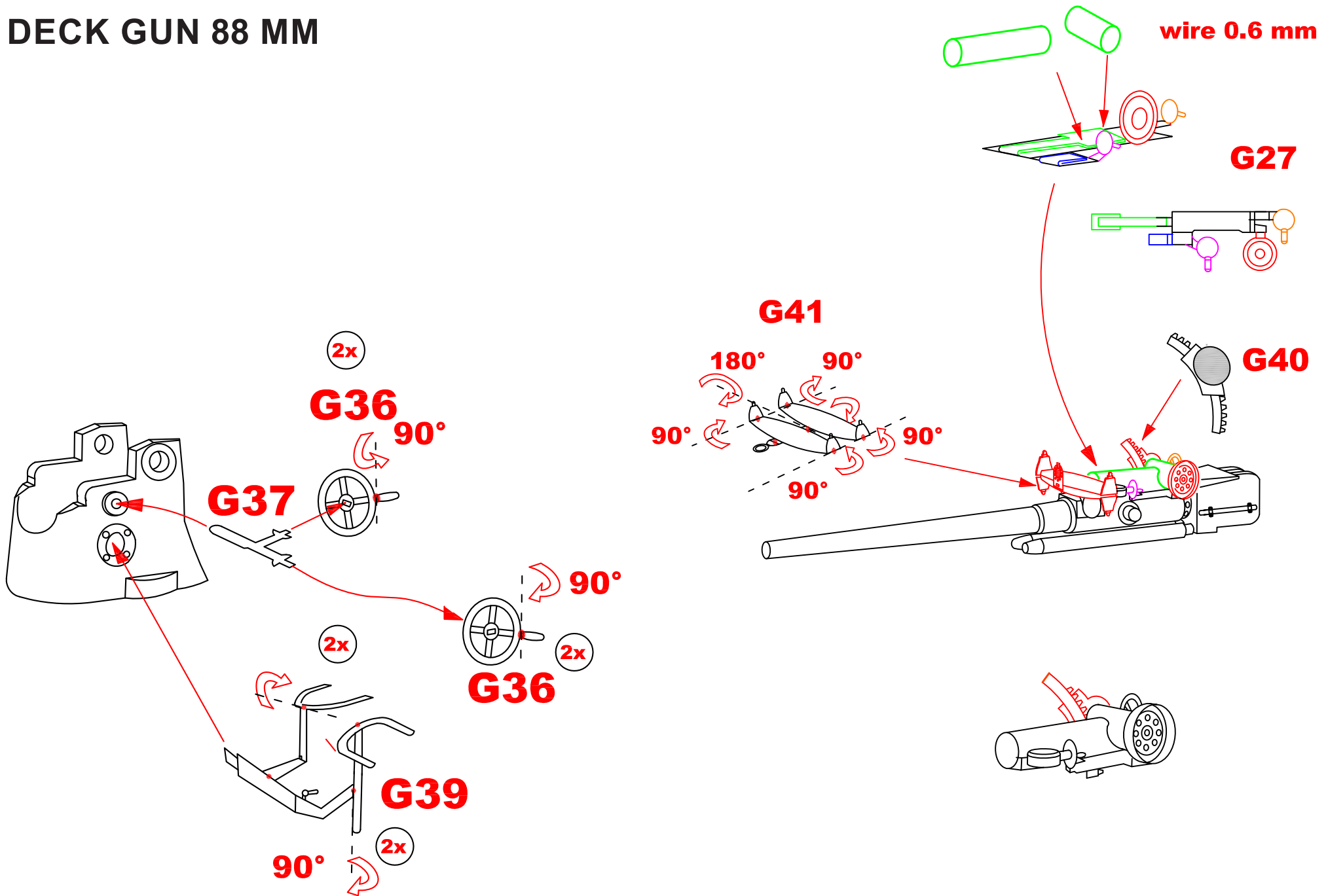



# TOWER

